

*Miss Central Pennsylvania  
Scholarship Pageant*

2010 Contestant Handbook

Pageant Date  
February 13, 2010

*Miss Central Pennsylvania  
Scholarship Pageant  
2010  
Contestant Handbook*

All Forms Require Adobe Reader



**Materials Included in This Handbook**

[Important Dates, Times, Phone Numbers and Ticket Information](#)

[Production Information](#)

[Stage Diagram](#)

[Judging of the Pageant](#)

[Ticket Order \*\*Form\*\*](#)

[Directions to the Super 8 Motel, the Quality Inn & Suites, the Best Western  
Nittany Milroy and the Original Italian Pizza Restaurant](#)

[Directions to Lewistown Area High School](#)

[Scholarship Rules](#)

All Forms Require Adobe Reader



## ***DATES, TIMES, PHONE NUMBERS AND PAGEANT TICKETS***

February 6, 2010 – A Photo Copy of Your Birth Certificate and Eligibility Documentation (If not previously submitted)

February 6, 2010 - **(MISS CONTESTANTS ONLY)** – Miss America 4 Kids Donation to Children's Miracle Network in the Amount of at least \$100 (or \$400 total for ALL local pageants in Pennsylvania). If not submitted online by February 6, please bring a check for \$100 (or the amount not yet submitted to CMN) made out to "Children's Miracle Network" with you to the pageant.

February 13, 2010 – Performance CD's or Tapes (Bring two copies with you to rehearsal if not previously submitted)

ASAP – Orders and Payment for Advance Sale Tickets. (See Ticket Order Form) The earlier you order the further front your tickets will be.

February 13, 2010 at 8:00 a.m. – Rehearsal at Lewistown Area High School (Please be early. We want to start at 8:00 a.m. Bring all costumes and your interview suit with you.

February 13, 2010 – Interviews at Lewistown Area High School

February 13, 2010 – Miss Central Pennsylvania Scholarship Pageant at the Lewistown Area High School (Show BEGINS at 7:30 p.m.)

February 13, 2010 through Spring of 2010 – Preparation for Miss Pennsylvania Orientation – Includes Wardrobe, Photographs, Talent Preparation, Paper Work for Miss Pennsylvania, etc. Also appearances promoting the pageant and helping prepare the winners for the job of Miss Pennsylvania.

May 8, 2010 – Miss Pennsylvania Orientation

May 8, 2010 to June 13, 2010 – Preparation for Miss Pennsylvania Pageant Continues – Emphasis on Interview, Wardrobe and Talent. Appearances also continue.

Week Before the Miss Pennsylvania Pageant – Miss Central Pennsylvania/Miss Greater Juniata Valley Press Conference and Send-Off to Miss Pennsylvania Pageant (Parents and Public Invited)

June 13 to June 19, 2010 – Miss Pennsylvania Pageant Week (Teens need to arrive on June 17).

### **PHONE NUMBERS**

John R. Metzger – (717) 248-5576 or (717) 250-3637 (Questions on Any Subject Concerning the Pageant including Pageant Production)

Ann Clark – (717) 248-7396 (Questions Concerning Tickets, Housing or Chaperones)

Dennis Clark – (717) 248-7396 (Questions Concerning Program Book Ads)

Rhonda Shawley – (814) 695-4170 – (Questions Concerning Judging of the Pageant)

**PAGEANT TICKETS**

All tickets on the main floor of the Auditorium are sold as Reserved Seats. The cost of tickets is \$15.00 for Adults, \$10.00 for Senior Citizens ages 62+, \$10 for children ages 6 to 16 and Free for children under age six. Seats in the Balcony are General Admission at a cost of \$10.00. Please note that some Balcony seating have an “obstructed view” of the stage.

It is recommended that you purchase Reserved Seats prior to the Pageant to get the best seating. The Reserved Seats that have not been previously purchased as well as General Admission Seats will be available at the High School the night of the Pageant.

Please contact Ann Clark for your Ticket needs.

BACK HALL

DRESSING ROOM

AUDITORS

JUDGES

GYMNASIUM lobby

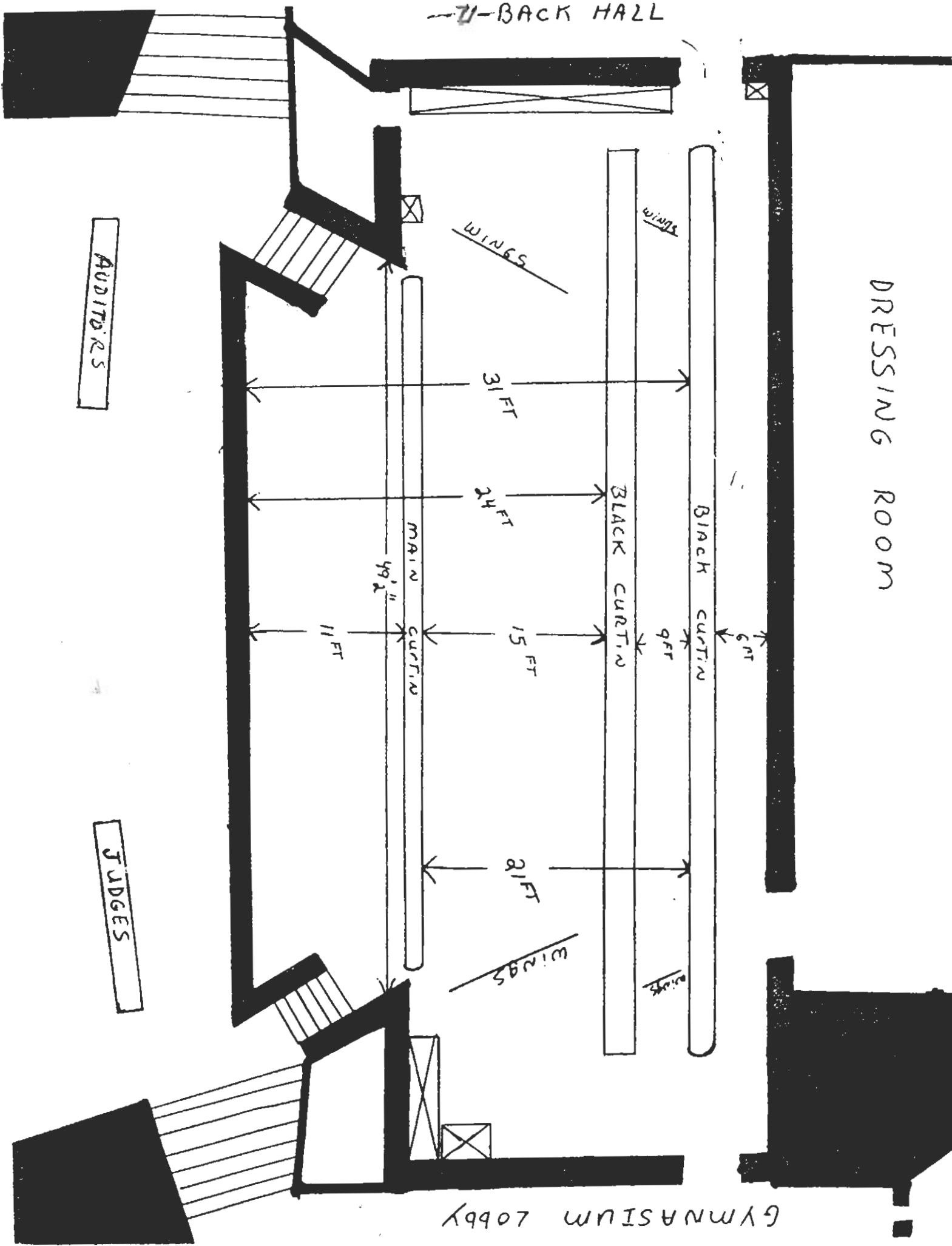

# *The Miss Central Pennsylvania Scholarship Organization*

*460 Dry Valley Road, Lewistown, PA 17044*

*Phone (717) 248-5576*

## **Judging of the Pageant**

### **Private Judging**

**Interview** - - Interviews with the "Miss" and "Teen" panels of judges will be conducted during the day on Saturday, February 13 at the Lewistown Area High School. All interviews are held in private. The "Miss" interviews will last ten (10) minutes and the "Teen" interviews will last seven (7) minutes. You will be introduced to the judges and the questions will start immediately. At the end of the formal interview you will be asked if there is something you would like to discuss that was not previously discussed. If so, the interview may continue for an additional thirty (30) seconds. If not, the interview ends at that point. The fact sheets and your critical issue normally serve as the basis for the interview questions. The interviews will be conducted with the judges seated and you standing in front of the judges panel. The interviews count for 25% of the scoring for the "Miss" and 35% for the "Teen" contestants. **PLEASE NOTE: THE LENGTH OF THE INTERVIEW MAY CHANGE BUT WILL BE THE SAME FOR ALL CONTESTANTS.**

### **On-Stage Judging**

**Lifestyle and Fitness in Swimsuit (Miss Contestants Only)** - - Swimsuits may be one or two piece. The suit should be in good taste and chosen to flatter you. Shoes of your choice, normally heels, will be worn in swimsuit competition. The swimsuit competition counts for 15% of the "Miss" scoring.

**Talent** - - Talent is limited to **2 minutes**. Talent counts for 35% of the scoring in both the "Miss" and "Teen" Pageants. You are reminded that there can be no "live" accompaniments.

**Evening Wear** - - Your evening wear outfit should be something that you as a young person would wear on an important evening out. Evening wear counts for 20% of the judging in the "Miss" Pageant and 15% in the "Teen" Pageant. Teens should bear in mind that your evening wear should probably not be as sophisticated as that worn by the Miss Contestants.

**Lifestyle and Fitness in Active Wear (Teen Contestants Only)** - - Active wear counts for 10% of the "Teen" judging. We would like all Teen Contestants to wear black yoga pants or capris with a pink colored workout tops. The top should not be a sports bra. **THIS IS TEEN FITNESS, NOT TEEN SWIMSUIT.**

**On-Stage Question** - - This score will be awarded following your opportunity to answer one (1) on-stage question. The questions will be asked while you are dressed in your interview suit. The on-stage interview score counts for 5% of the judging for both "Miss" and "Teen" Contestants. "Miss" contestant's questions will be taken from their Platform Essays. "Teen" contestants will select a question from a "fish bowl." The questions will concern problems facing teens in today's society.

***All judging to this point is done individually on a 1 to 10 scoring system. The high and low scores of each contestant in each phase of competition are dropped. There is no group judging where you are compared against other contestants.***

## **Top Five Judging**

**Top Five** – The names of the Top Five contestants, based on the scoring above, are given to the panel of judges. **In a local pageant, the names of this Top Five are not announced to the audience or contestants.** Each of the judges will arrive at a score based on their overall perception of the contestant. The contestant considered by a judge to be the “best” contestant will be given a score of “10.” The next contestant will be given a “5,” the next a “3,” the next a “2” and the final contestant, a “1.” Highs and lows will **not** be dropped and the judges’ total scores will determine the winners and runner-ups..

# *Miss Central Pennsylvania Scholarship Pageant*

Saturday, February 13, 2010 at 7:30 p.m.  
Lewistown Area High School - Lewistown, PA

## TICKET PRICES

Reserved Seats – In order to keep your seats together, order together)

Adults - \$15.00

Senior Citizens (Ages 62+) - \$10.00

Children (Ages 7 to 16) - \$10.00

Children Age 6 and Under– Free

Ticket Mailing Fee - \$2.00 per order

General Admission (Balcony) - \$10.00 (At the Door Only)

## TICKET ORDER FORM

\_\_\_\_\_ Adult Tickets @ \$15.00

\_\_\_\_\_ Senior Citizen Tickets (Ages 62+) @ \$10.00

\_\_\_\_\_ Ages 7 to 16 Tickets @ \$10.00

\_\_\_\_\_ Children Age 6 and Under (Free)

\_\_\_\_\_ Tickets for Current Titleholders or Local Directors (Free)  
(Titleholder must wear crown/Director must have Miss PA Badge – List Pageant Affiliation)

\_\_\_\_\_ Total Tickets

Mailing Fee (\$2.00) (If not paid, your tickets will be held at the door.)

\_\_\_\_\_ Amount Enclosed

Name: \_\_\_\_\_

Address: \_\_\_\_\_

City, State & Zip: \_\_\_\_\_

Email: \_\_\_\_\_ Phone Number: \_\_\_\_\_

Please make checks payable to Miss Central Pennsylvania Scholarship Pageant and mail to:  
*Tickets*

*Miss Central Pennsylvania Scholarship Pageant  
Ann Clark, Ticket Chairperson  
1475 Middle Road  
Lewistown, PA 17044*

Ticket orders received after February 6, 2010 will be held for you at the ticket window.

PLEASE KEEP A COPY OF YOUR ORDER FOR YOUR FILES

**To:** Contestants, Parents and Other Visitors to Lewistown

**From:** John R. Metzger, Executive Director

**Re:** Directions to the Super 8 Motel (Phone 717-242-8888) and Dining

**From Harrisburg, Carlisle and other points east of Lewistown**

From Harrisburg, take U.S. 22/322 west. Just before arriving in Lewistown U.S. 322 west continues straight and U.S. 22 business route bears right. At this point, follow U.S. 322 west toward State College. You will pass two exits into Lewistown. The third exit will be marked "Burnham-Yeagertown" exit. Take that exit. Go to the stop sign and turn right. Go to the next stop sign and again turn right. Cross over U.S. 322. The Super 8 Motel will be to your right.

**From State College and other points northwest of Lewistown**

From State College, take U.S. 322 east. About 28 miles from State College you will come to the "Burnham/Yeagertown" exit. Get off at that exit. At the end of the exit turn right. The Super 8 Motel is on your right.

**From Altoona and other points west of Lewistown**

From Hollidaysburg, take U.S. 22 into Lewistown. When the road splits to go toward Harrisburg or State College, follow U.S. 322 west toward State College. Take that first exit from U.S. 322 west (Burnham/Yeagertown exit. Go to the stop sign and turn right. Go to the next stop sign and again turn right. Cross over U.S. 322. The Super 8 Motel will be to your right.

**From Selinsgrove and other points northeast of Lewistown**

From Selinsgrove, take U.S. 522 south. Shortly after entering Lewistown you will see a sign to U.S. 322 west (State College).

Make the right hand turn and follow U.S. 322 west. You will pass one exit into Lewistown. The second exit will be marked the “Burnham/Yeagertown” exit. Take that exit. Go to the stop sign and turn right. Go to the next stop sign and again turn right. Cross over U.S. 322. The Super 8 Motel will be to your right.

**From Huntingdon County using PA 655**

From Huntingdon County, follow PA 655 until you arrive at U.S. 322 east. Follow U.S. 322 east to the first exit. It is marked the Burnham-Yeagertown” exit. Take that exit. At the end of the ramp turn right. The Super 8 Motel will be on your right.

*Other major hotels in the Lewistown area include the Quality Inn and Suites, also located at the “Burnham/Yeagertown” exit from U.S. 322 and the Best Western Nittany Inn Milroy at the Milroy exit from U.S. 322 (about 10 miles west of Lewistown going toward State College).*

*We recommend the Original Italian Pizza Restaurant in Burnham for dining. The restaurant can be found by driving into Burnham. At the second traffic light, turn right onto Logan Boulevard. The restaurant will be in front of you on your left.*

*The Miss Central Pennsylvania  
Scholarship Organization*

*460 Dry Valley Road, Lewistown, PA 17044*

*Phone (717) 248-5576*

## **Directions to Lewistown Area High School**

**From State College and points to the northwest:** Take the exit from U.S. 322 marked East Charles Street. Go to the second traffic light (South Main Street). Turn left on South Main Street and Follow South Main Street to Fleming Avenue (just past the Lake Ford-Lincoln-Mercury dealership) — (if you pass the Lake Chevrolet-Geo-Oldsmobile-Saab dealership, you have gone too far). Turn left on Fleming Avenue. After about three blocks, the Lewistown Area High School will be on your right.

**From Hollidaysburg/Altoona and points to the west:** Follow U.S. 22/522 east toward Lewistown from Mount Union (Do not follow Business Route 22 into Lewistown). Merge into U.S. 22/322 east. Take the exit marked East Charles Street and follow the directions above from State College.

**From Selinsgrove and points to the northeast:** Follow U.S. 522 south into Lewistown. Follow the signs marked "To U.S. 322 east" and "To U.S. 22 east" toward Harrisburg. Take the exit from U.S. 322 marked East Charles Street and follow the directions from State College.

**From Harrisburg and points to the southeast:** Follow U.S. 22/322 into Lewistown. When U.S. 322 bears left toward State College, veer right on Business Route 22 west toward Lewistown. A short distance ahead Business Route 22 west veers left. At that point take the South Main Street exit. Follow South Main Street. You will see the Lake Chevrolet-Geo-Oldsmobile-Saab dealership and a UniMart on your right. Continue to the next corner (Fleming Avenue) and turn right. Follow Fleming Avenue about three blocks. The Lewistown Area High School will be on your right.

**From the Super 8 Motel, the Quality Inn & Suites and the Best Western Nittany Milroy:** Get on U.S. 322 east. Follow the directions above from State College.

## **Scholarship Rules (“Miss” Pageant)**

### **The Miss Central Pennsylvania Scholarship Organization**

**Effective August, 15, 1993**

- 1) Scholarships shall be expended for tuition and related expenses, room and board and other educational expenses approved by the Miss Central Pennsylvania Scholarship Organization Executive Committee.
- 2) Requests for scholarships are processed upon receipt of statements from colleges and schools or for other educational expenses. All statements and invoices must be accompanied by a cover letter from the contestant. Requests for other educational expenses (e.g. private instructors) must be pre-approved by the Miss Central Pennsylvania Scholarship Organization Executive Committee.
- 3) Scholarships may be used for current educational expenses. Contestants may submit invoices for payment directly from the provider of the service or may submit a receipted bill and request reimbursement. All invoices and requests must be originals. Contestants may not request payment or reimbursement for expenses which are or have been covered through any other financial aide source (other than student loans which meet the provisions of paragraph #4 below.
- 4) Scholarships may be used for outstanding student loan obligations provided the loan is not in default and provided the student has satisfactorily completed the coursework for which the loan was obtained. Contestants must submit documentation from the school or lender which shows that the Contestant is either the primary or secondary payer of the loan obligation. Notice of payments due should be sent to the Miss Central Pennsylvania Scholarship Organization for payment. If the time required for processing the invoice extends beyond the due date, the contestant may submit proof of payment and request reimbursement.
- 5) Scholarships may be used for future educational expenses. Contestants must begin use of their scholarships with two (2) years (three (3) years should she be named Miss Pennsylvania) of the date of the award. If a contestant has no activity in her scholarship account during this period, the funds in her account will be forfeited.
  - a) A Contestant who begins use of her scholarship within the time designated above, will then be required to show continuous activity in her scholarship endeavors up to a limit of four (4) years following the date of the award. If there occurs a two (2) year period in which there is no activity in an account, then the balance of that account will be forfeited. Similarly any balance remaining in a Contestant’s account four (4) years following the date of the award will be forfeited.
  - b) An exception to the time limits described above may be made if the Contestant, prior to the expiration date, makes a written appeal to the Miss Central Pennsylvania Scholarship Organization Executive Committee citing compelling reasons why the time period should be extended. The Miss Central Pennsylvania

Scholarship Organization Executive Committee will review the request and determine whether or not an extended time period is warranted. The decision of the Miss Central Pennsylvania Scholarship Organization Executive Committee shall be final and binding.

- 6) Scholarships which have been forfeited will remain in the scholarship account for future awards.
- 7) Awards in lieu of scholarships are available. Contestants who are college graduates and do not intend to continue their college education may elect to receive an award in lieu of a scholarship. The award will be  $\frac{1}{2}$  the value of all scholarship monies the Contestant would have been awarded. It is understood that a Contestant who qualifies for and accepts this award waives her right to any scholarships she may have won in the Miss Central Pennsylvania Scholarship Pageant. Such scholarship monies will be forfeited and distributed as outlined above.
  - a) Contestants who wish to apply for the award listed must do so in writing to the Miss Central Pennsylvania Scholarship Organization by one (1) year following the date of the award.
  - b) Any balance remaining in a Contestant's account one (1) year following the date of the award will be forfeited.